

Always a  
cut ahead!



Glow-wire cutting device SPEWE GT127-34 



**SPEWE.** 

## Convincing details

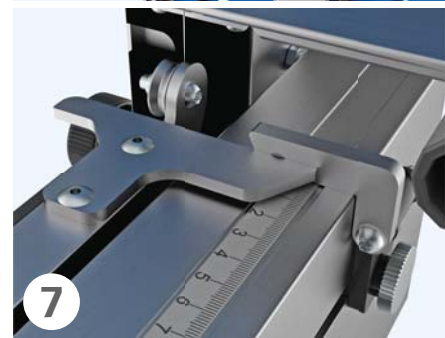
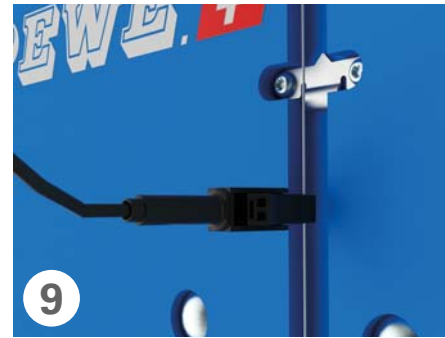
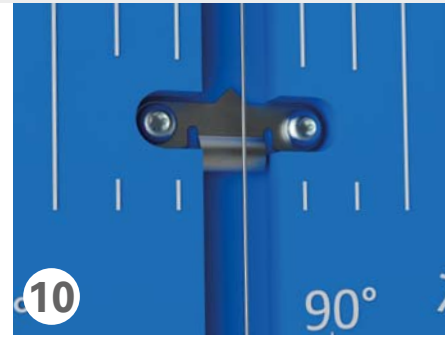
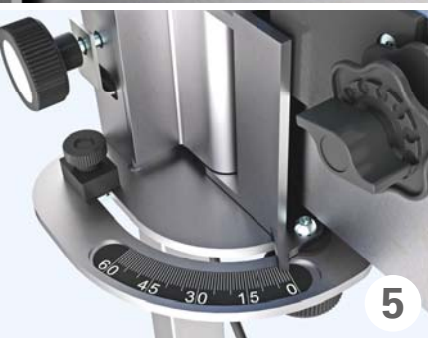

## Types of cuts

straight

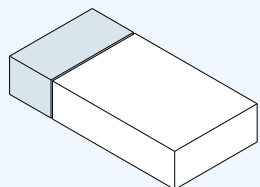

mitre

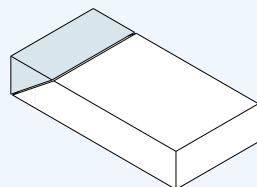

groove

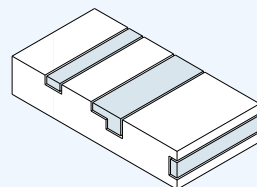

stepped groove

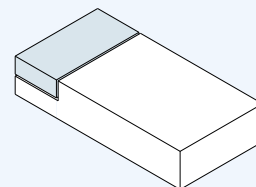

step/rabbit

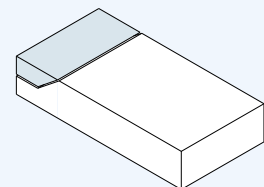

# Glow-wire cutting device

## Installation positions

11



12



- 1 Telescopic bow cutter length for user-friendly operation on the scaffold
- 2 Infinitely variable incline slide - combined with wire adjustment
- 3 Push button to operate cutting device
- 4 Spare wire spool with latching mechanism for quick and tool-free wire changing
- 5 Digital display with gauge for repetitive cuts
- 6 Horizontally and vertically arranged bracing supports ensure optimal board guidance
- 7 Foldable, stable depth-stopper to easily and quickly set plate depth
- 8 Battery trough and current controller housing with connection box for cutting bow (or corner cutter)
- 9 Eco-tap for longer battery life, wire is only heated over limited length, up to 200 cuts possible with one battery charge
- 10 Burn-in protection plate with integrated tip for exact wire adjustment
- 11 Standing unit with free-standing support
- 12 Use of the device without free-standing support leaned against wall or scaffolding

step with mitre

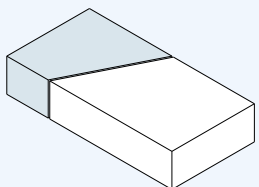

bevel

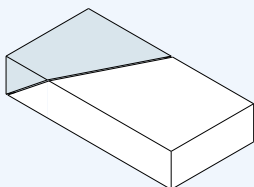

bevel with mitre

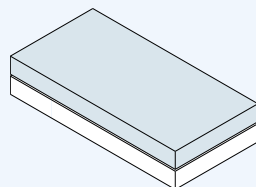

straight cut

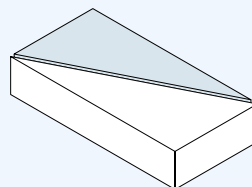

diagonal

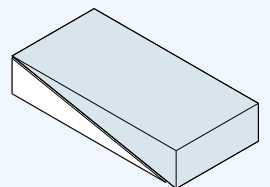



## Accessories for SPEWE GT127-34

### Optionally available

Battery set with 2 x batteries 18V 5.0Ah and quick charger



Free-standing support



Corner cutter ES-GT127-34A



Transport case



### The product

Robust glow-wire floor-mounted cutting device SPEWE GT127-34 Battery for polystyrene panels with adjustable bow cutter length and infinitely adjustable carriage for gradient cuts up to approx. 7°. Height-adjustable stand. Mobile use. Up to 200 cuts possible with 1 battery charge thanks to the powerful battery.

### Technical Data

- Cutting depth at 90°: 340 mm
- Cutting depth at 45°: 220 mm
- Cutting length: 780 - 1280 mm
- Weight: 16.0 kg

### Delivery information

SPEWE GT127-34 Battery cutting device, bracket track on both sides, corner cutter track. Without battery set.

Spewe is a partner of the CAS Alliance. 1 Battery for everything.



### Spewe AG

Hauptstrasse 332  
Gewerbegebiet Mösli  
CH-5326 Schwaderloch

Phone: +41 56 203 03 30  
Website: [www.spewe.ch](http://www.spewe.ch)